



Adjustable Camber Plate - Installation Instructions

Part #2152210

Cars applicable:
996/997 C4 and Turbo

Parts List

Quantity	Description
2	Front Camber Plate Assembly (One left, one Right)

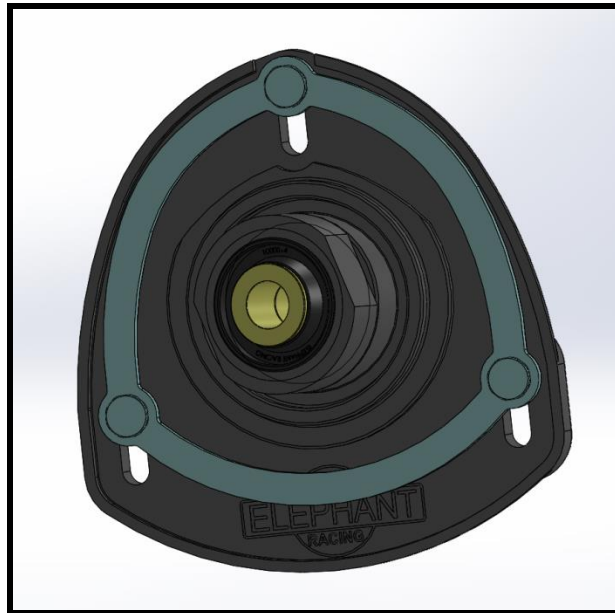

Tools Required:

Basic Mechanic's Tool set

Introduction:

Congratulations on your selection of Elephant Racing Camber Plates.

Quick-change Camber Plates increase the available camber adjustment range. They replace the compliant factory rubber strut top bushings with spherical bearing to enhance driving precision and improve damper performance.

Our fully sealed camber plates feature PTFE lined monoballs requiring no supplemental lubrication or additional maintenance.

Configurations:

This kit can be used in one of two configurations as listed below. Please follow the installation steps for your specific application:

1. Stock or "lowering" springs
2. Coil-over setup

Step-by-Step Installation -

Stock or Lowering Springs

1 – Refer to an appropriate shop manual for the procedure to safely raise and support the vehicle. Remove the Front Wheels.

2 – Remove the factory camber plates per an appropriate shop manual.

3 – Remove the factory spring seat from the factory camber plate. These parts will be used with the Elephant Racing camber plates.

The Elephant Racing camber plates are labeled "Left" and "Right." Be sure to install each camber plate on the correct side.

Important: Do not reuse factory top cupped washer!

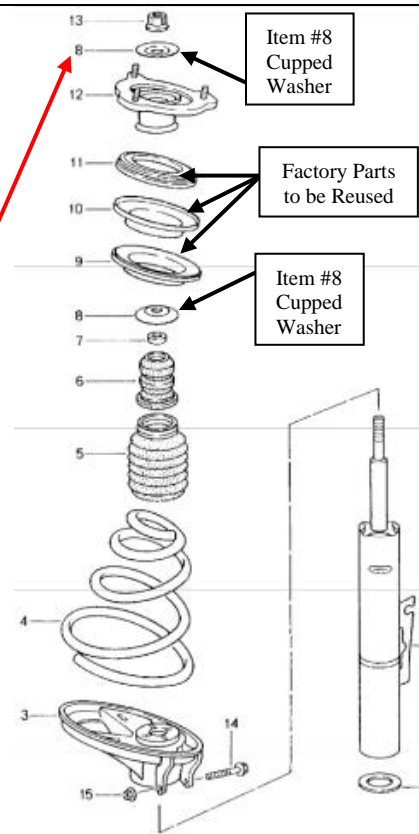

4 – Slip the Elephant Racing Camber Plates onto the struts reusing the factory spring seat and bearing. Install the strut top nut finger tight.

5 – Seat the camber plate in the chassis and tighten the three mounting nuts finger tight.

6 – Torque the main strut nut and three mounting nuts per side to factory specifications.

7 – Install the wheels and safely lower the vehicle. Test drive the vehicle to ensure everything is tight and working as intended.

8 – Align vehicle.

Coil-over setup

1 – Refer to an appropriate shop manual for the procedure to safely raise and support the vehicle. Remove the Front Wheels.

2 – Remove the factory camber plates per an appropriate shop manual.

The Elephant Racing camber plates are labeled "Left" and "Right." Be sure to install each camber plate on the correct side.

3 – A non-factory spring perch, such as is included with a von shock system, will need to be used for this kit to accommodate a coil-over setup.

With the appropriate spring perch for your application, slip the spring perch and Elephant Racing camber plate onto the strut. Tighten the top nut finger tight.

Do not reuse either factory cupped washer! (shown on page 2 as item #8 in diagram)

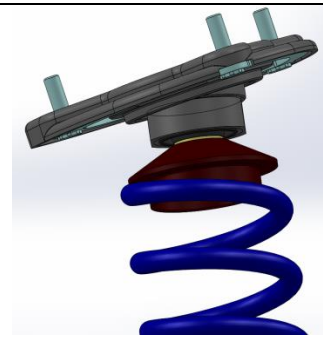

4 – Seat the camber plate in the chassis. Install three factory original mounting nuts per side, finger tight.

5 – Align vehicle.

6 – Torque the main strut nut and three mounting nuts per side to factory specifications.



Camber Adjustment:

Adjusting camber on the Elephant Racing Camber Plate is the same as the stock adjustment procedure: Loosen the three top locking nuts and slide the camber plate in towards the middle of the car for more negative camber, out for less. Raise the car to unload the suspension before adjusting the camber setting. Check your camber with a camber gauge. Securely torque the nuts to the factory spec once the desired camber is set.